

To: Class of 2022

From: Dr. Christopher Dunlap, College Marshal

Re: Commencement Mass: May 13, 2022 4:00PM (Arrival time 3:45)

The Commencement Mass is one of the major ceremonies (including hooding ceremonies) that lead up to Commencement. It is time to thank God for the blessings bestowed on the graduating students during their four years at Saint Mary's College. This year Commencement mass will be held:

Friday May 13 at 4:00 PM in O'Laughlin Auditorium

Guests are welcome to attend and there is no limit on the number.

Attire

This is an academic and liturgical ceremony, so academic regalia is required to participate. This means cap, gown and hood. Approved academic cords, medals and stoles may also be worn.

Procession

All graduates (both undergraduate and graduate students) will assemble on the second floor of Moreau Hall outside of the Little Theater/Galleries **by 3:45 p.m.** on Friday, May 13th. Form a double line in the hallway of equal numbers. Unlike Commencement, the **line** you are in and the **order** you are in *do not matter*. Nor does it matter if undergraduates and graduate students are mixed together. If you want to sit next to your friends, they will need to be in your same *line* and not across from you in the other line. See the diagram below. *To avoid congestion coming into O'Laughlin, please enter directly into Moreau via the entrance marked below.*

The procession moves at exactly 4:00 p.m.

Marshals will lead the two lines out of the Art wing of Moreau, onto the Miller Arcade and into the lobby of O'Laughlin Auditorium. The lines will then split and proceed down each aisle in the Auditorium. The two sides will fill in alternate rows. Please move all the way to the end of the row and fill each seat. Follow the Marshal's instructions as we process in.

Please remain standing as the liturgical party comes in behind us.

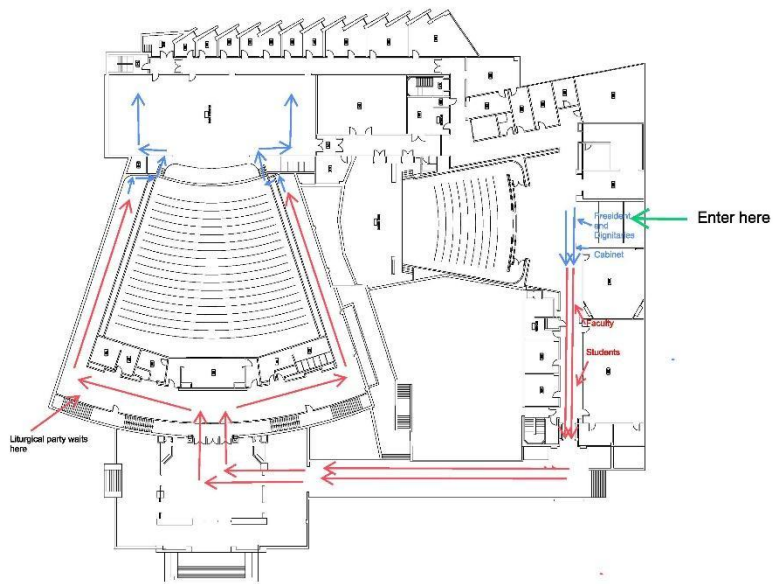

The reception of communion will be done in place; you will not leave your seat, but servers will come to you.

Recession

When the mass is completed you will be instructed to leave by the marshals and follow the liturgical party out. You will continue out of the row the same direction you went in, so you will go out the opposite side. You will go out and up to the O'Laughlin Lobby, and then back down the Miller Arcade, or down the stairs in front (depending on the weather).